



**Oxfordshire** 44 Horton View  
Banbury  
Oxfordshire  
OX16 9HP  
t. 01295 709247

**Yorkshire** 3 New Street  
York  
YO1 8RA  
t. 01904 848868

This drawing has been produced for Swanhome Developments Ltd. for the Full Planning Application for the Residential development at Yew Tree Farm, Thorganby and is not intended for use by any other person or for any other purpose.

© Walker Graham Architects Limited (UK) 2019.

Measurements scaled from plans cannot be guaranteed to be accurate. Use figured dimensions only. Only original drawings should be relied upon.

WG origin filename: WG664 All\_B.pln

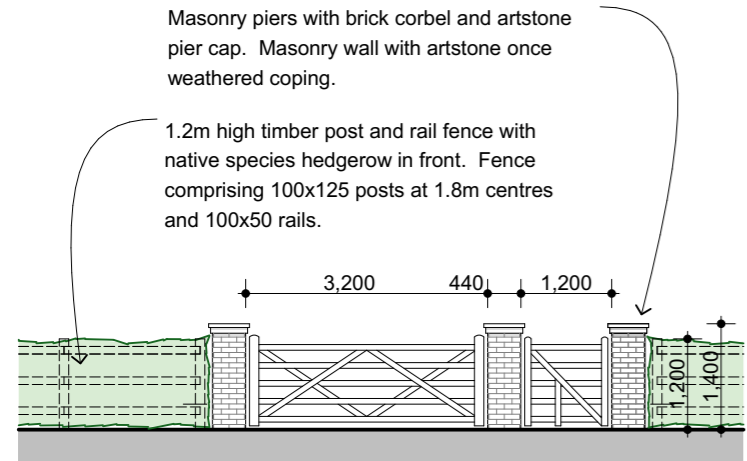

PLOT 4 & 5 GATE ELEVATION

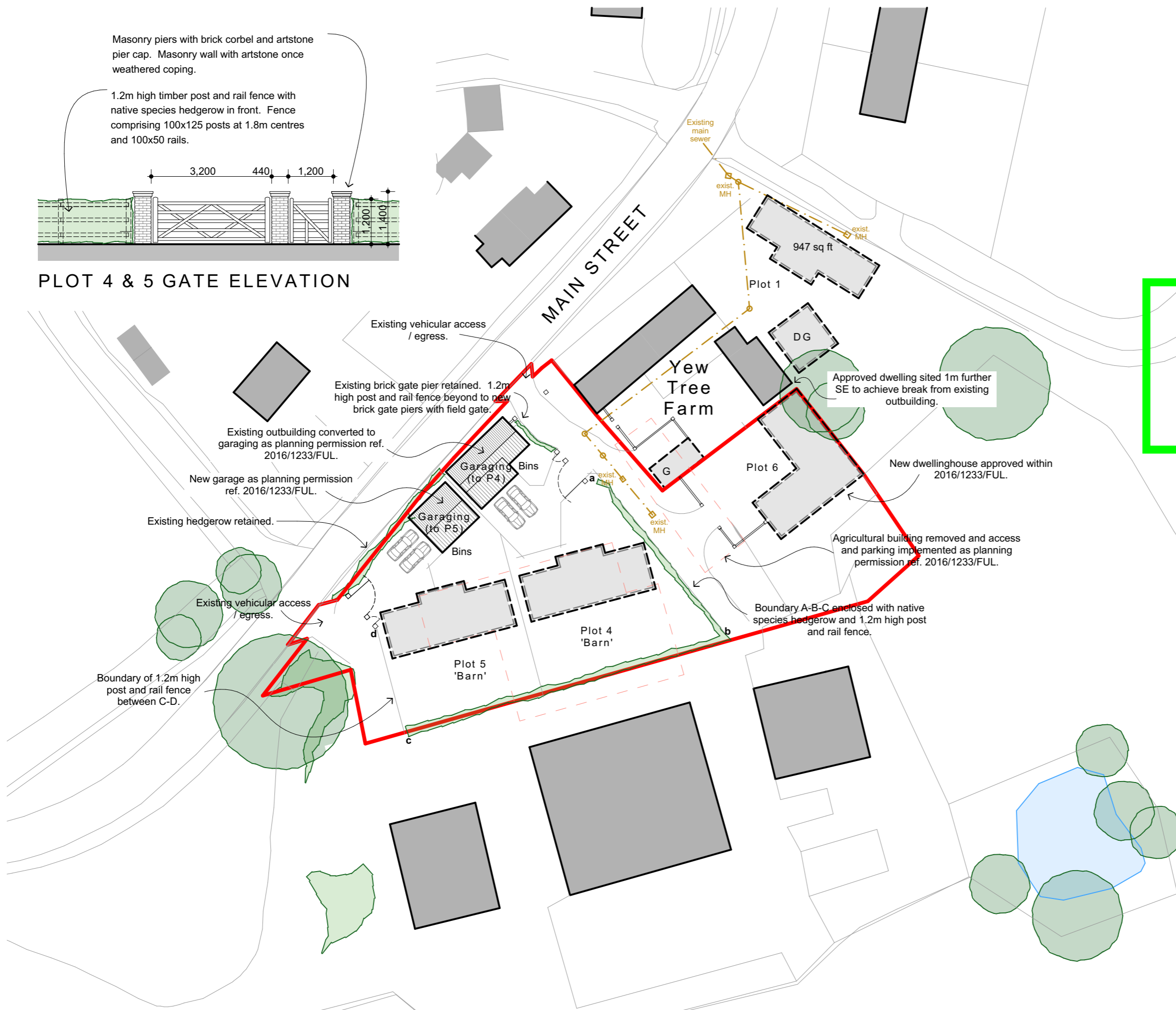

**AMENDED  
DRAWING**

- rev. M (20.11.19) Developed to LPA preferred scheme.
- rev. L (11.11.19) Coordinated with drawing 06 I.
- rev. K (28.10.19) Revised to indicative footprint of P4 and P5.
- rev. J (02.09.19) Revised to FS comment.
- rev. I (21.08.19) Revised for P4 and P5 PLF.
- rev. H (26.04.19) Revised to FS instruction.
- rev. G (18.01.19) Revised to Client instruction 16.01.19.
- rev. F (10.12.18) Revised to Client instruction received 07.11.18.
- rev. E (03.12.18) Approved Site Plan ref 2016/1233/FUL underlain.
- rev. D (10.09.18) Plot numbers added.
- rev. C (24.08.18) Application site boundary revised to P4, P4 and 5.
- rev. B (13.07.18) Corrected to DC-A dwg 105.
- rev. A (12.07.18) Application site boundary revised. Flood Zone 2 added.



Project  
**Residential development  
Yew Tree Farm, Thorganby**  
for  
Swanhome Developments Ltd.

Drawing title  
**Proposed Site Plan**

Drawing scale  
**1:500, 1:100 at A3**

Drawing date  
**May 2018**

Drawing no. **WG664 - 03 M**

www.walkergraham.co.uk  
email: architecture@walkergraham.co.uk